

# IAQ Map Legend - Summer Operation

**Natural ventilation:** Operable windows and/or louvres should be used to manage fresh air, balancing thermal comfort and ventilation.

**Mechanical ventilation:** Fresh air is introduced by the heating, ventilation and air conditioning system when in operation. Windows can remain closed and no action is required by the school.

**Note:** White spaces are to be used in accordance with COVID-19 requirements and current health advice.

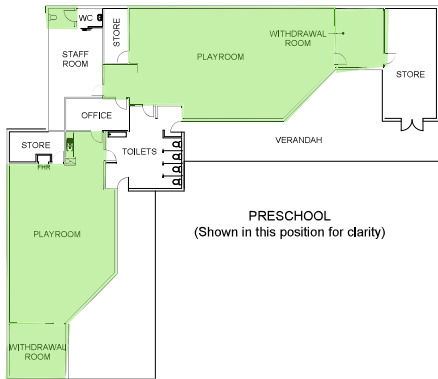
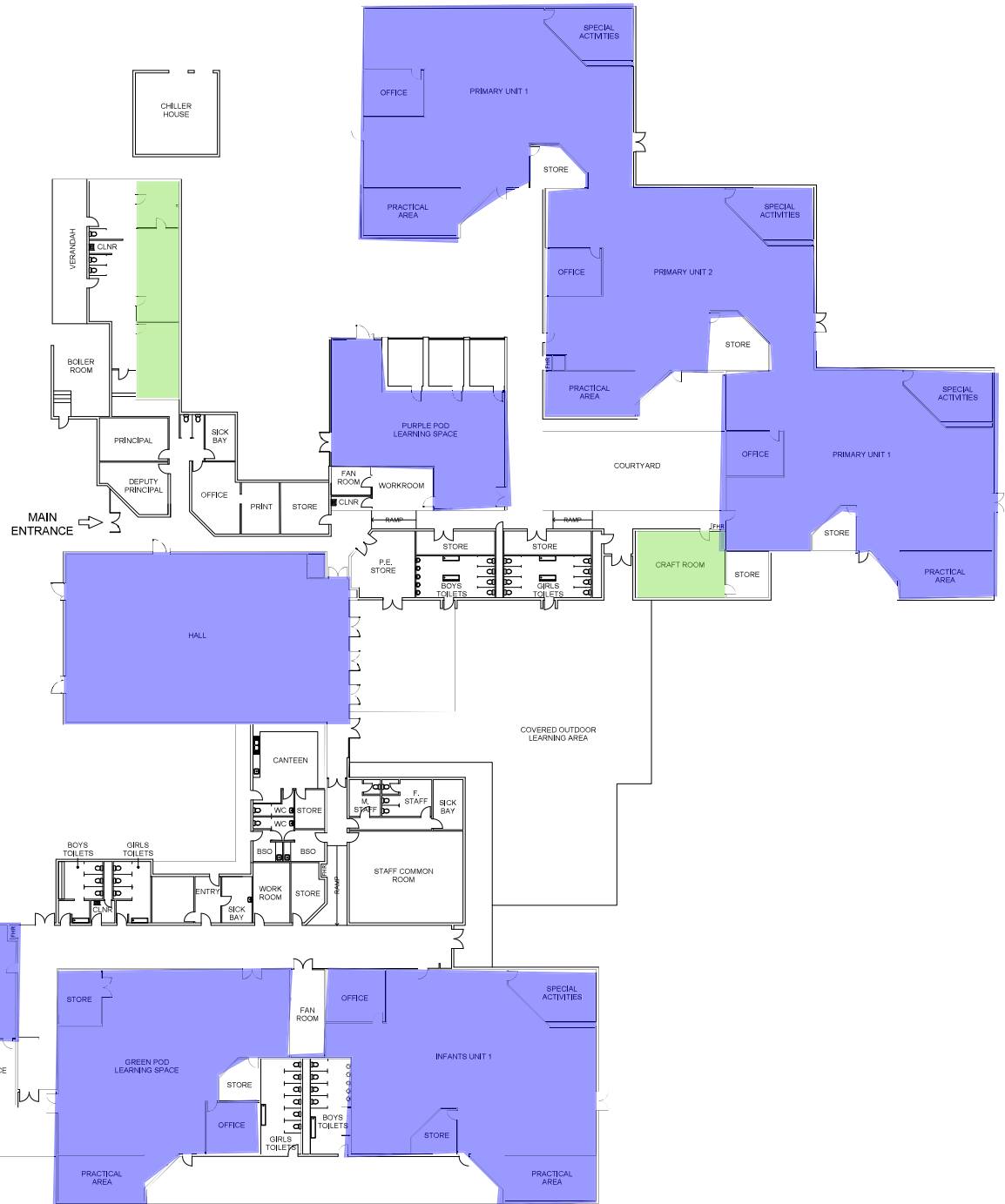

| ISSUE | AMENDMENT | DRAWN | VERD | APPD | DATE |
|-------|-----------|-------|------|------|------|
|       |           |       |      |      |      |
|       |           |       |      |      |      |
|       |           |       |      |      |      |
|       |           |       |      |      |      |

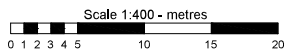

SCALE  
1:400  
DATE  
JANUARY 2018  
DRAWING SHEET SIZE = A3



PROJECT  
WANNIASSA JUNIOR SCHOOL  
INFRASTRUCTURE & CAPITAL WORKS  
SCHOOL LAYOUT PLAN